

标记	处数	更改内容	版本	签名	时间

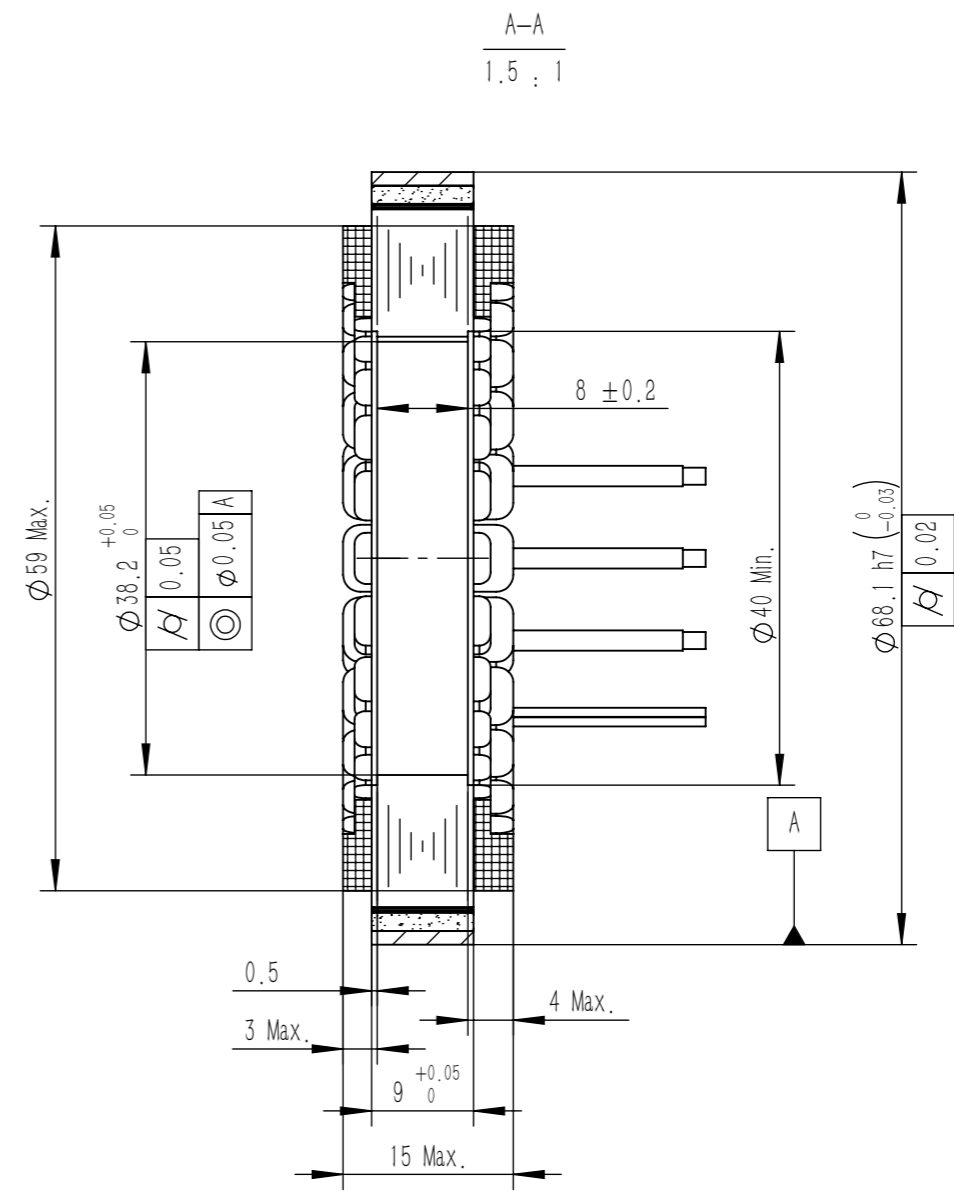

Wire: #14AWG black, white, red, corresponding to V, W, W
 Wire length 250mm
 Temperature control wire: #26AWG, yellow and green wires, length: 250mm
 Temperature Coefficient Thermistor: CA-NTC24C018

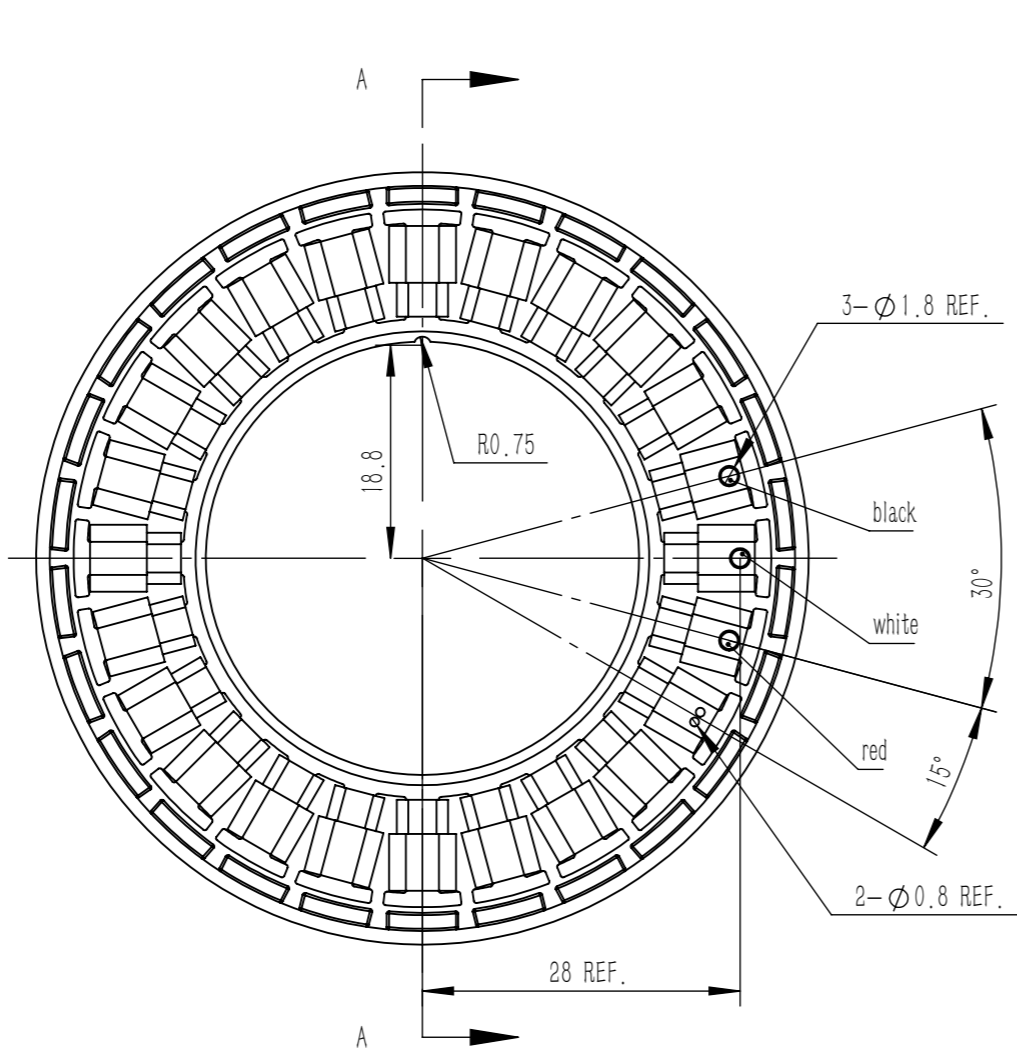
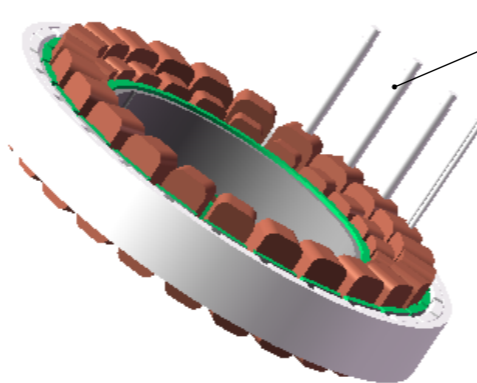

零件代号

Motor Parameter

Model	UE6815
Voltage (V)	48V DC
Rated output (W)	199.12
Rated torque (Nm)	0.76
Instant max torque (Nm)	1.9
Rated current (Arms)	5
Instant max current (Arms)	15
Rated speed (Rpm)	2500
Max speed (Rpm)	3570
Torque constant (Nm/Arms)	0.15
Rotor inertia (kg.cm ²)	0.29
Back EMF coefficient (V/Krpm)	13.4
Resistance (Ω)	1.1
Inductance (mH)	0.5
Number of pole-pairs (P)	13

Basic Size	Selection Level				Angle
	A	B	C	D	
≤5	±0.02	±0.03	±0.05		0°~30° ±0.1°
>5~20	±0.03	±0.05	±0.1		31°~60° ±0.3°
>20~50	±0.05	±0.1	±0.15		61°~90° ±0.5°
>50~100	±0.1	±0.15	±0.2		
>100	±0.1%	±0.15%	±0.2%		

No.	WI-UE6815DJA01	Describe	UE6815 Frameless Torque Motor	
Materials		Sheet	Number	Versions
Date	2026/4/3	A3	1	A
Design	Fenghua Wang	Page- / Pages-		
Check		MOSRAC		
Approve				

