

标记	处数	更改内容	版本	签名	时间

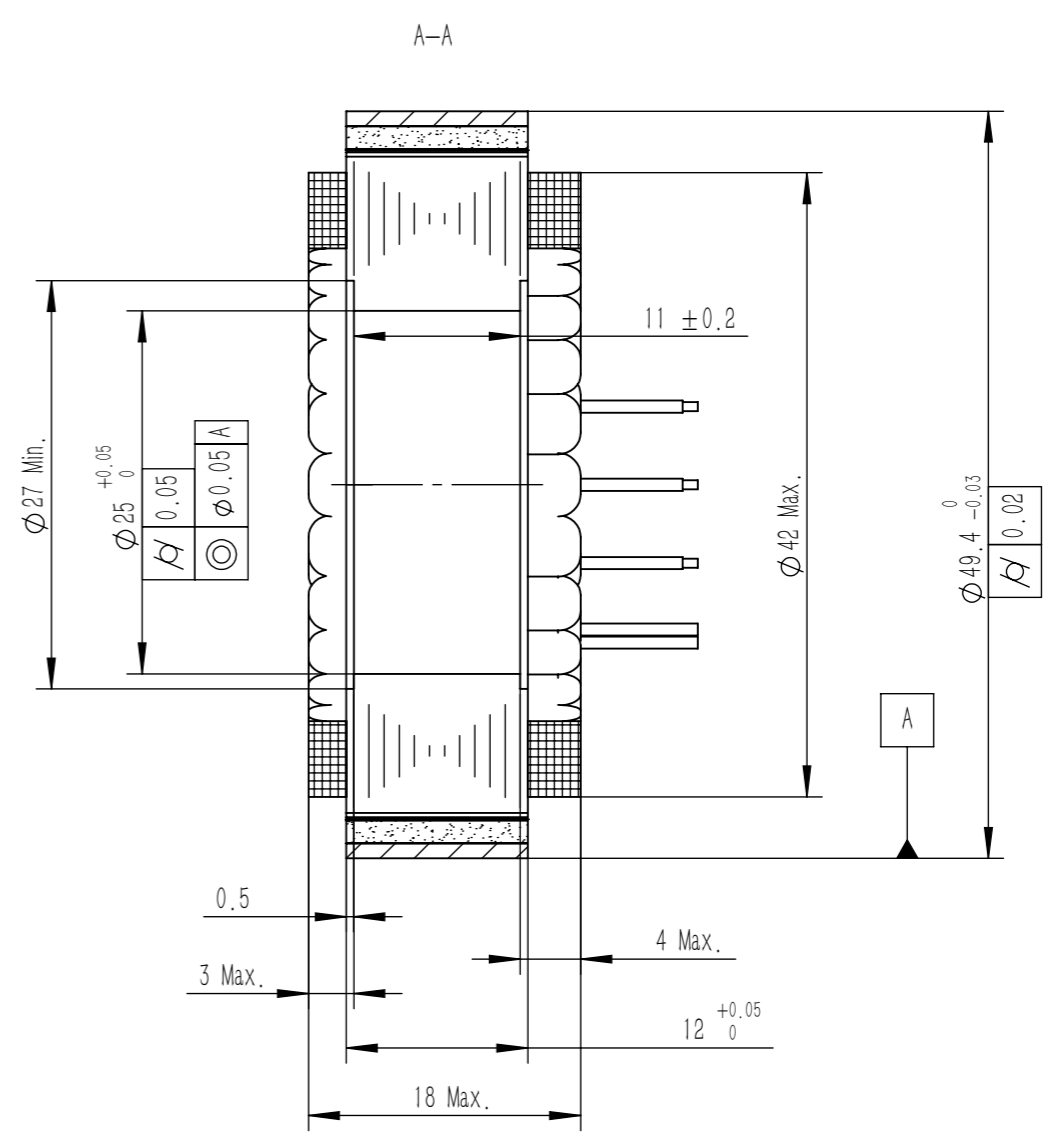
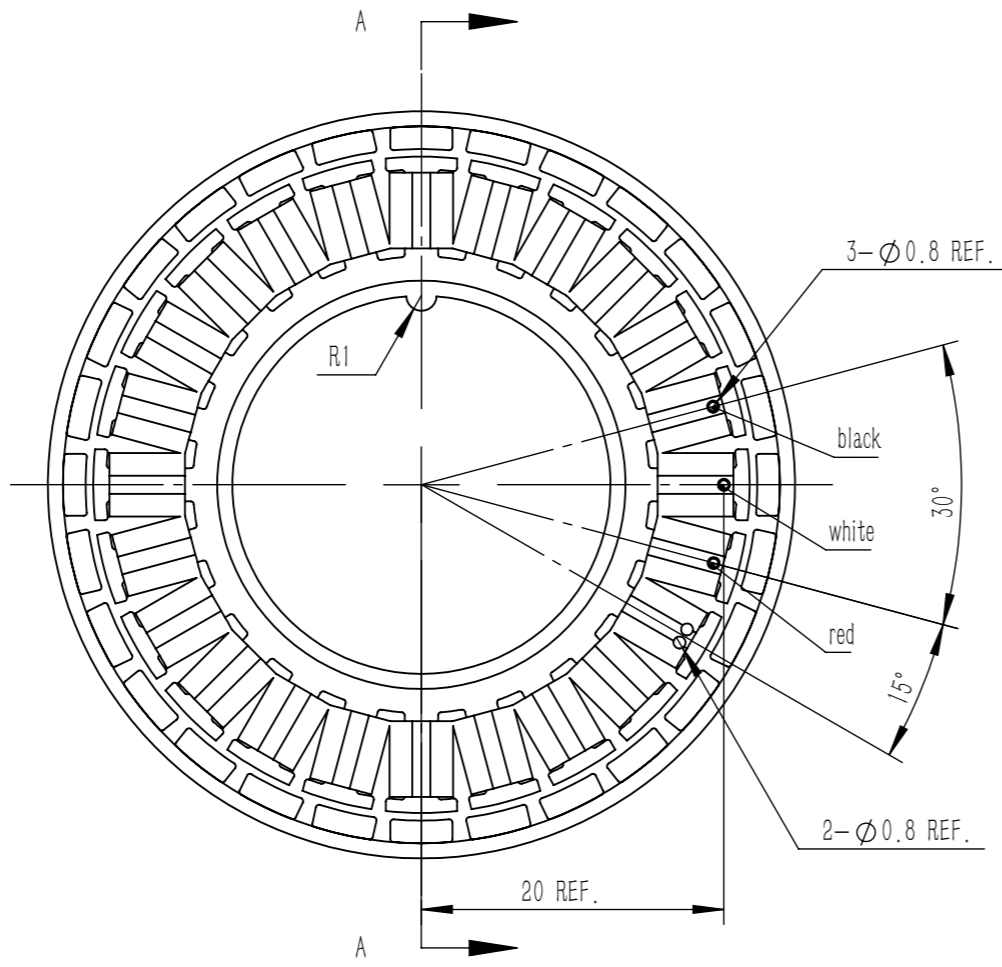

零件代号

借(通)用件登记

Motor Parameter

Model	UE4918
Voltage (V)	48V DC
Rated output (W)	70.74
Rated torque (Nm)	0.27
Instant max torque (Nm)	0.62
Rated current (Arms)	1.5
Instant max current (Arms)	3.5
Rated speed (Rpm)	2500
Max speed (Rpm)	3020
Torque constant (Nm/Arms)	0.18
Rotor inertia (kg.cm ²)	0.13
Back EMF coefficient (V/Krpm)	15.8
Resistance (Ω)	3.6
Inductance (mH)	0.82
Number of pole-pairs (P)	14

Wire: #26AWG black,white,red,corresponding to V, W, W
 Wire length 250mm
 Temperature control wire: #26AWG, yellow and green wires, length: 250mm
 Temperature Coefficient Thermistor: CA-NTC24C018

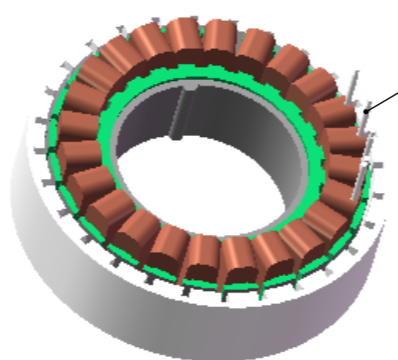

Unmarked Linear Size Tolerance&Angle Reference Table					
Basic Size	Selection Level				Angle
	A	B	C	D	
≤5	±0.02	±0.03	±0.05		0°~30° ±0.1°
>5~20	±0.03	±0.05	±0.1		31°~60°
>20~50	±0.05	±0.1	±0.15		±0.3°
>50~100	±0.1	±0.15	±0.2		61°~90°
>100	±0.1%	±0.15%	±0.2%		±0.5°

No.	WI-UE4918DJA01	Describe	UE4918 Frameless Torque Motor		
Materials		Sheet	A3	Number	1
Date	2026/4/3	Versions			A
Design	Fenghua Wang	Page- / Pages-			
Check		MOSRAC			
Approve					