

标记	处数	更改内容	版本	签名	时间

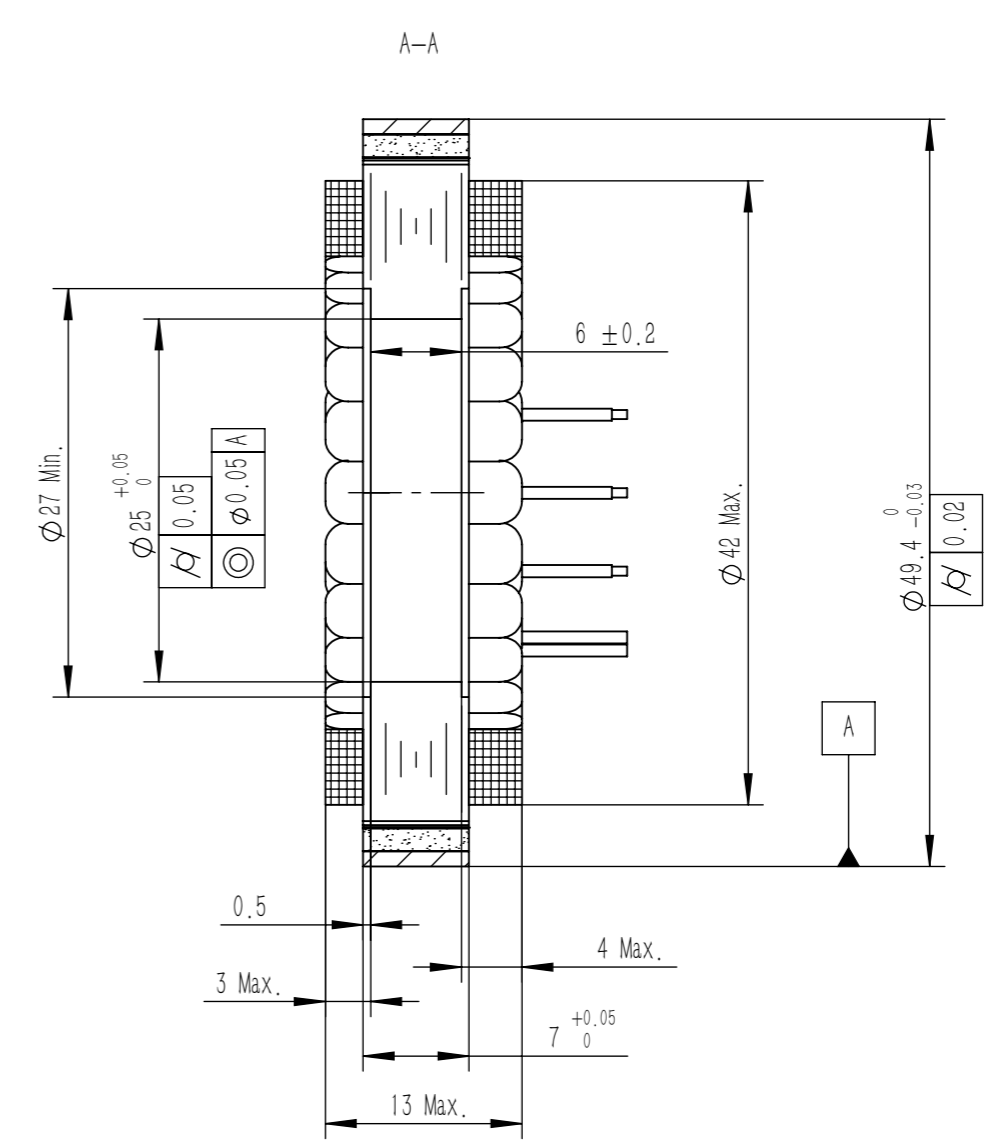
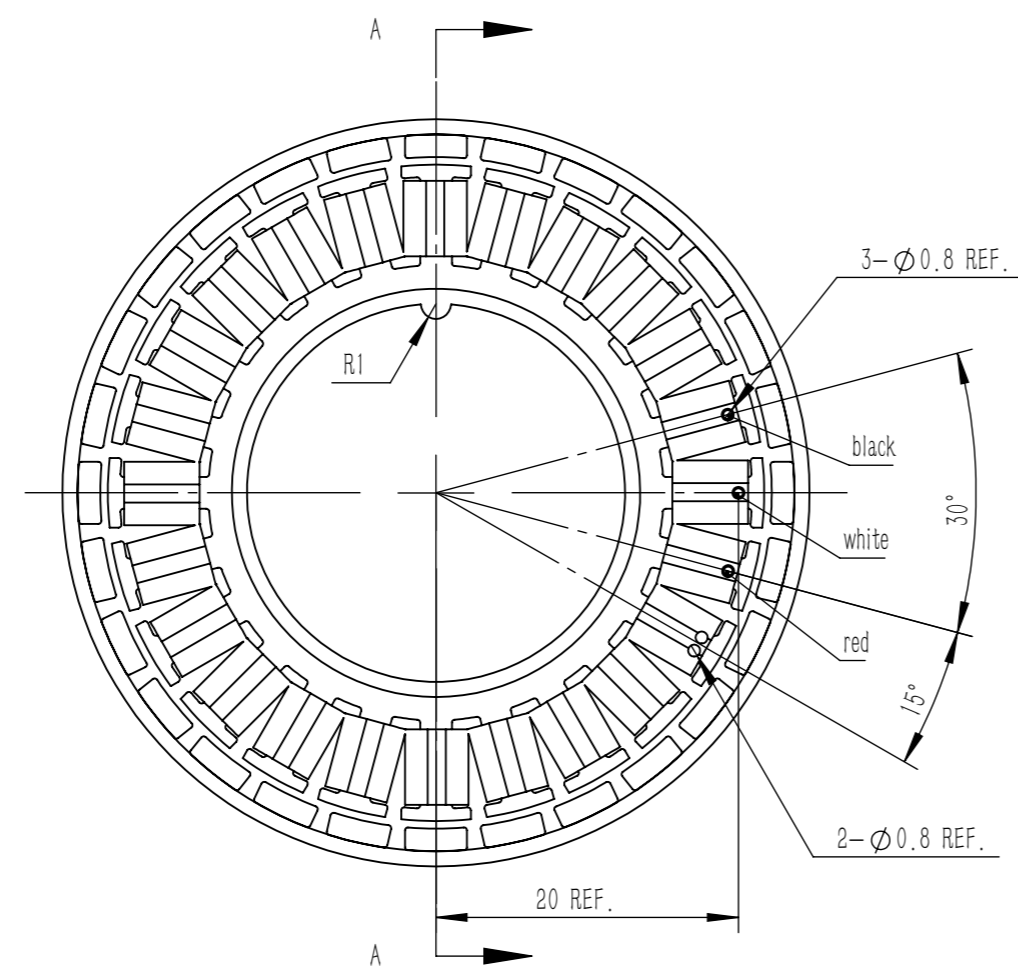

零件代号

Motor Parameter

Model	UE4913
Voltage (V)	48V DC
Rated output (W)	70.43
Rated torque (Nm)	0.14
Instant max torque (Nm)	0.33
Rated current (Arms)	1.5
Instant max current (Arms)	3.5
Rated speed (Rpm)	4800
Max speed (Rpm)	5600
Torque constant (Nm/Arms)	0.09
Rotor inertia (kg.m ²)	0.25
Back EMF coefficient (V/Krpm)	8.6
Resistance (Ω)	2.8
Inductance (mH)	0.47
Number of pole-pairs (P)	14

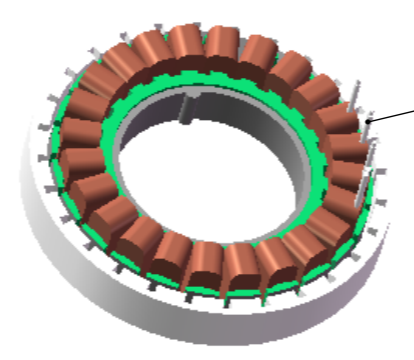

Wire: #26AWG black,white,red,corresponding to V, W, W
 Wire length 250mm
 Temperature control wire: #26AWG, yellow and green wires, length: 250mm
 Temperature Coefficient Thermistor: CA-NTC24C018

Basic Size	Selection Level				Angle
	A	B	C	D	
≤5	±0.02	±0.03	±0.05		0°~30° ±0.1°
>5~20	±0.03	±0.05	±0.1		31°~60°
>20~50	±0.05	±0.1	±0.15		±0.3°
>50~100	±0.1	±0.15	±0.2		61°~90°
>100	±0.1%	±0.15%	±0.2%		±0.5°

No.	WI-UE4913DJA01	Describe	UE4913 Frameless Torque Motor	
Materials		Sheet	Number	Versions
Date	2026/4/3	A3	1	A
Design	Fenghua Wang	Page- / Pages-		
Check		MOSRAC		
Approve				

