

| 标记 | 处数 | 更改内容 | 版本 | 签名 | 时间 |
|----|----|------|----|----|----|
| | | | | | |
| | | | | | |
| | | | | | |

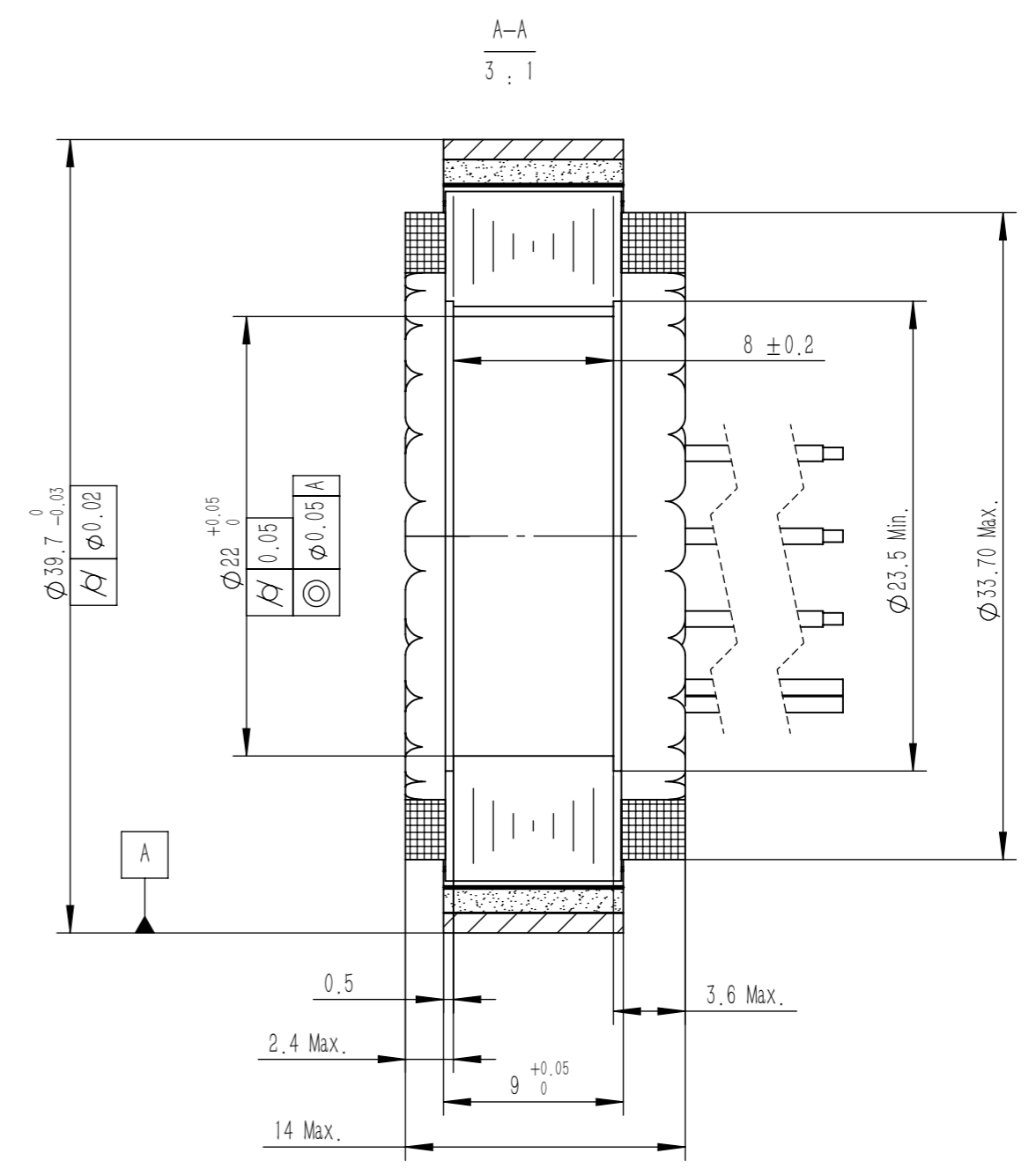
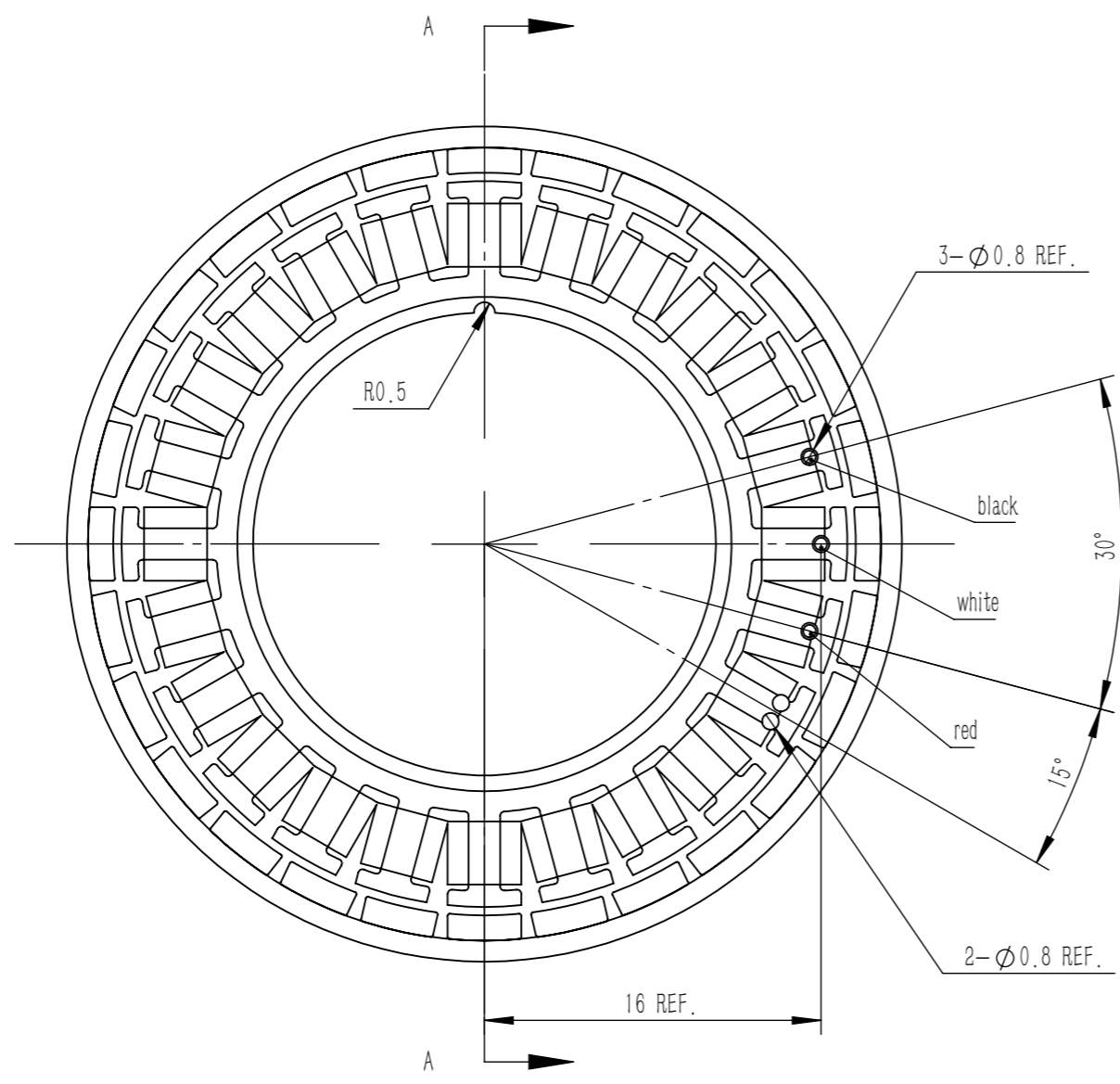

零件代号

借(通)用件登记

Motor Parameter

| | |
|-------------------------------------|----------|
| Model | UE4014 |
| Voltage (V) | 24V DC |
| Rated output (W) | 2.6, 2.0 |
| Rated torque (Nm) | 0.1 |
| Instant max torque (Nm) | 0.27 |
| Rated current (Arms) | 1.5 |
| Instant max current (Arms) | 4 |
| Rated speed (Rpm) | 2500 |
| Max speed (Rpm) | 3850 |
| Torque constant (Nm/Arms) | 0.07 |
| Rotor inertia (kg.cm ²) | 0.043 |
| Back EMF coefficient (V/Krpm) | 6.2 |
| Resistance (Ω) | 3.12 |
| Inductance (mH) | 0.27 |
| Number of pole-pairs (P) | 14 |

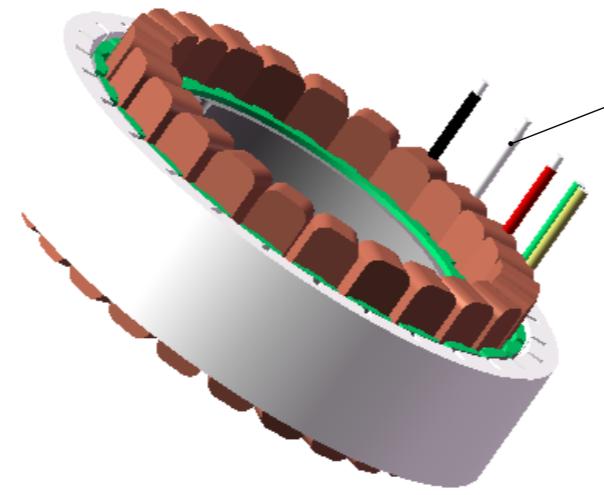

Wire: #26AWG black, white, red, corresponding to V, W, W
 Wire length 250mm
 Temperature control wire: #26AWG, yellow and green wires, length: 250mm
 Temperature Coefficient Thermistor: CA-NTC24C018

| Basic Size | Selection Level | | | | Angle |
|------------|-----------------|--------|-------|---|------------------|
| | A | B | C | D | |
| ≤5 | ±0.02 | ±0.03 | ±0.05 | | 0°~30° ±0.1° |
| >5~20 | ±0.03 | ±0.05 | ±0.1 | | 31°~60° ±0.3° |
| >20~50 | ±0.05 | ±0.1 | ±0.15 | | 61°~90° ±0.5° |
| >50~100 | ±0.1 | ±0.15 | ±0.2 | | |
| >100 | ±0.1% | ±0.15% | ±0.2% | | |

| | | | | | |
|-----------|----------------|----------------|-------------------------------|--------|---|
| No. | WI-UE4014DJA01 | Describe | UE4014 Frameless Torque Motor | | |
| Materials | | Sheet | A3 | Number | 1 |
| Date | 2026/4/3 | Versions | | | A |
| Design | Fenghua Wang | Page- / Pages- | | | |
| Check | | MOSRAC | | | |
| Approve | | | | | |

