

# FE-263 series DD Motor(External Rotor)

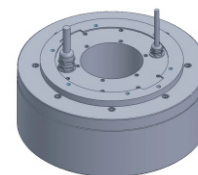

MAIN PARAMETERS	FE-263113	FE-263138	FE-263163	FE-263188
Voltage(VAC)	220	220	220	220
Rated torque (Nm)	95.0	150.0	210	250.0
Instant Max Torque (Nm)	190	300	420	500
Torque constant (Nm/Arms)	13.4	21.9	29.6	35.2
Rated Current (Arms)	7.1	7.1	7.1	7.1
Instant Max Current (Arms)	14.2	14.2	14.2	14.2
Resistance (Ω)	2.7	3.9	2	6.7
Inductance (mH)	8.3	13.4	7	22.8
Pole-pairs number (2P)	20	20	23	20
Back EMF coefficient (Vrms/rad/s)	10.9	17.9	10.1	28.7
Rated Output (W)	796.5	943.2	1760.6	1310.0
Rotor inertia 10 <sup>-4</sup> kg.m <sup>2</sup>	1000	1500	1600	2100
Rated Speed (rpm)	80	60	80	50
Max Speed (rpm)	150	120	150	100
Positioning accuracy(arc_sec)	± 20	± 20	± 20	± 20
Repeat positioning accuracy (arc_sec)	± 1.5	± 1.5	± 1.5	± 1.5
Encoder resolution (sin/cos)	16384	16384	16384	16384
Axial load (N)	40000	40000	40000	40000
Radial load (N.m)	400	400	400	400
Axial runout (mm)	≤0.005	≤0.005	≤0.005	≤0.005
Radial runout (mm)	≤0.005	≤0.005	≤0.005	≤0.005
Weight (kg)	24.4	32.5	44	49.1
Motor height L(mm)	113	138	163	188

## Specification & drawing

